

# CAME

## TRIPOD TURNSTILES

FA00384-EN



INSTALLATION MANUAL

# XVIA STAND-ALONE

EN English



**WARNING!**  
**important safety instructions for people:**  
**READ CAREFULLY!**



**PREMISE**

• THIS PRODUCT SHOULD ONLY BE USED FOR THE PURPOSE FOR WHICH IT WAS EXPLICITLY DESIGNED. ANY OTHER USE IS DANGEROUS. CAME S.p.A. IS NOT LIABLE FOR ANY DAMAGE CAUSED BY IMPROPER, WRONGFUL AND UNREASONABLE USE • THE SAFETY OF THIS PRODUCT AND ITS PROPER FITTING DEPENDS, THEREFORE, ON RESPECTING ITS TECHNICAL CHARACTERISTICS AND PROPER FITTING, TO BE DONE IN STATE-OF-THE-ART FASHION, AND UNDER SAFE CONDITIONS AS EXPRESSLY EXPLAINED IN THE LITERATURE THAT COMES WITH THE PRODUCT • KEEP THESE WARNINGS TOGETHER WITH THE INSTALLATION AND OPERATION MANUALS THAT COME WITH THE OPERATOR.

**BEFORE INSTALLING**

*(CHECKING WHAT'S THERE: IF SOMETHING IS MISSING,  
DO NOT CONTINUE UNTIL YOU HAVE COMPLIED  
WITH ALL SAFETY PROVISIONS)*

• FITTING AND TESTING MUST BE ONLY PERFORMED BY QUALIFIED TECHNICIANS • LAYING THE CABLES, INSTALLATION AND TESTING MUST FOLLOW STATE-OF-THE-ART PROCEDURES AS DICTATED BY REGULATIONS • BEFORE BEGINNING ANY OPERATION IT IS MANDATORY TO CAREFULLY READ ALL INSTRUCTIONS; IMPROPER INSTALLATION MAY RESULT IN SERIOUS HARM TO PEOPLE AND THINGS. • MAKE SURE THE OPERATOR IS IN GOOD MECHANICAL STATE, BALANCED AND ALIGNED, AND THAT IT OPENS AND CLOSES PROPERLY. ALSO, IF NEEDED, FIT SUITABLE PROTECTIONS OR USE PROPER SAFETY SENSORS • MAKE SURE THAT THE OPENING TURNSTILE CANNOT RESULT IN ANY HAZARDS • DO NOT INSTALL THE OPERATOR ONTO SURFACES THAT COULD YIELD AND BEND. IF NECESSARY, ADD SUITABLE REINFORCEMENTS TO THE ANCHORING POINTS • ONLY INSTALL ON A LEVEL SURFACE • MAKE SURE ANY SPRINKLER SYSTEMS CANNOT WET THE OPERATOR FROM THE GROUND UP.

**INSTALLING**

• SUITABLY SECTION OFF AND DEMARCATÉ THE ENTIRE INSTALLATION SITE TO PREVENT UNAUTHORIZED PERSONS FROM ENTERING THE AREA, ESPECIALLY MINORS AND CHILDREN • BE CAREFUL WHEN HANDLING OPERATORS THAT WEIGH OVER 25 KG. IF NEED BE, USE PROPER SAFETY HOISTING EQUIPMENT • THE CE-MARKED SAFETY DEVICES, MUST BE FITTED IN COMPLIANCE WITH THE REGULATIONS IN EFFECT AND ACCORDING TO STATE-OF-THE-ART CRITERIA, TAKING INTO ACCOUNT THE ENVIRONMENT, THE TYPE OF REQUIRED SERVICE AND OF THE WORKING FORCES APPLIED TO MOVING TURNSTILES. ANY CRUSHING SHEARING OR CONVEYING POINTS MUST BE SUITABLY PROTECTED • ANY RESIDUAL RISKS MUST BE POINTED OUT TO END USERS AND HIGHLIGHTED WITH PICTOGRAMS AS PROVIDED BY THE LAW • ALL OPENING COMMANDS (THAT IS, BUTTONS, KEY SWITCHES, MAGNETIC READERS, AND SO ON) MUST BE INSTALLED AT LEAST 1.85 M FROM THE PERIMETER OF THE TURNSTILE'S WORKING AREA, OR WHERE THEY CANNOT BE REACHED FROM OUTSIDE THE TURNSTILE. ALSO, ANY DIRECT COMMANDS (BUTTONS, TOUCH PANELS, AND SO ON) MUST BE INSTALLED AT LEAST 1.5 M FROM THE GROUND AND MUST NOT BE REACHABLE BY UNAUTHORIZED PERSONS • THE TURNSTILE MUST CLEARLY DISPLAY ITS OWN IDENTIFICATION DATA • BEFORE CONNECTING THE TURNSTILE TO THE POWER SUPPLY MAKE SURE THAT THE IDENTIFICATION DATA MATCH THE NETWORK DATA • THE TURNSTILE MUST BE CONNECTED TO AN EFFICIENT, STATE-OF-THE-ART GROUNDING SYSTEM • THE MANUFACTURER DECLINES ANY LIABILITY FOR USING NON-ORIGINAL PRODUCTS; WHICH WOULD RESULT IN WARRANTY LOSS • BEFORE DELIVERING TO THE USERS, MAKE SURE THE SYSTEM IS EN 12453 AND EN 12445 STANDARD COMPLIANT, AND ALSO MAKE SURE THE SYSTEM HAS BEEN PROPERLY ADJUSTED AND THAT ANY SAFETY, PROTECTION AND MANUAL RELEASE DEVICES ARE WORKING PROPERLY • APPLY WARNING SIGNS WHERE NECESSARY AND IN A VISIBLE PLACE.

**SPECIAL INSTRUCTIONS  
AND RECOMMENDATIONS FOR USERS**

• KEEP TURNSTILE OPERATION AREAS CLEAN AND FREE OF ANY OBSTRUCTIONS. MAKE SURE THE PHOTOCELL'S OPERATING FIELD IS CLEAR OF ANY OBSTRUCTIONS • DO NOT ALLOW CHILDREN TO PLAY WITH FIXED COMMANDS, OR TO LOITER IN THE TURNSTILE'S MANEUVERING AREA. KEEP ANY REMOTE CONTROL TRANSMITTERS OR ANY OTHER COMMAND DEVICE AWAY FROM CHILDREN, TO PREVENT THE OPERATOR FROM BEING ACCIDENTALLY ACTIVATED • THE APPARATUS MAY BE USED BY CHILDREN OF EIGHT YEARS AND ABOVE AND BY PHYSICALLY, MENTALLY AND SENSORY-CHALLENGED PEOPLE, OR EVEN ONES WITHOUT ANY EXPERIENCE, PROVIDED THIS HAPPENS UNDER CLOSE SUPERVISION OR ONCE THEY HAVE BEEN PROPERLY INSTRUCTED TO USE THE APPARATUS SAFELY AND TO THE POTENTIAL HAZARDS INVOLVED. CLEANING AND MAINTENANCE BY USERS MUST NOT BE DONE BY CHILDREN, UNLESS PROPERLY SUPERVISED. • FREQUENTLY CHECK THE SYSTEM FOR ANY MALFUNCTIONS OR SIGNS OF WEAR AND TEAR OR DAMAGE TO THE MOVING STRUCTURES, TO THE COMPONENT

PARTS, ALL ANCHORING POINTS, INCLUDING CABLES AND ANY ACCESSIBLE CONNECTIONS. KEEP ANY HINGES, MOVING JOINTS AND FRICTION POINTS PROPERLY LUBRICATED • PERFORM FUNCTIONAL CHECKS ON THE PHOTOCELLS AND SENSITIVE SAFETY EDGES, EVERY SIX MONTHS. CONSTANTLY CLEAN THE PHOTOCELLS' GLASS COVERS USING A SLIGHTLY WATER-MOISTENED CLOTH; DO NOT USE SOLVENTS OR CHEMICALS THAT COULD DAMAGE THE DEVICES • IF REPAIRS OR MODIFICATIONS ARE REQUIRED TO THE SYSTEM, CUT OFF THE MAIN POWER SUPPLY AND DO NOT USE IT UNTIL SAFETY CONDITIONS HAVE BEEN RESTORED • CUT OFF THE POWER SUPPLY BEFORE PERFORMING ANY MANUAL OPENINGS. IF THE POWER SUPPLY CABLE IS DAMAGED, IT MUST BE REPLACED BY THE MANUFACTURER OR AUTHORIZED TECHNICAL ASSISTANCE SERVICE, OR IN ANY CASE, BY SIMILARLY QUALIFIED PERSONS, TO PREVENT ANY RISK • IT IS FORBIDDEN FOR USERS TO PERFORM ANY OPERATIONS THAT ARE NOT EXPRESSLY REQUIRED OF THEM. FOR ANY REPAIRS, MODIFICATIONS AND ADJUSTMENTS AND FOR EXTRA-ORDINARY MAINTENANCE, CALL TECHNICAL ASSISTANCE • LOG THE JOBS AND CHECKS INTO THE PERIODIC MAINTENANCE LOG.

**ADDITIONAL INSTRUCTIONS AND RECOMMENDATIONS  
FOR EVERYONE**

• KEEP AWAY FROM AND DO NOT LOITER NEAR THE BARRIER AND MECHANICAL MOVING PARTS • DO NOT ENTER THE BARRIER'S AREA OF OPERATION WHEN IT IS MOVING • DO NOT COUNTER THE OPERATOR'S MOVEMENT AS THIS COULD RESULT IN DANGEROUS SITUATIONS • ALWAYS PAY SPECIAL ATTENTION TO ANY DANGEROUS POINTS, WHICH HAVE TO BE LABELED WITH SPECIFIC PICTOGRAMS AND/OR BLACK AND YELLOW STRIPES • WHEN USING A SELECTOR SWITCH OR A COMMAND IN MAINTAINED ACTION MODE, KEEP CHECKING THAT THERE ARE NO PERSONS WITHIN THE OPERATING RANGE OF ANY MOVING PARTS, UNTIL THE COMMAND IS RELEASED • THE TURNSTILE MAY MOVE AT ANY TIME AND WITHOUT WARNING • ALWAYS CUT OFF THE MAINS POWER SUPPLY BEFORE PERFORMING ANY MAINTENANCE OR CLEANING.

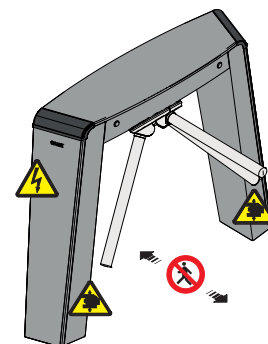

*DANGER OF HAND CRUSHING*





*DANGER! HIGH VOLTAGE.*



*No TRANSITING WHILE THE BARRIER IS MOVING*

## LEGEND

-  This symbol shows which parts to read carefully.
-  This symbol shows which parts describe safety issues
-  This symbol shows which parts to tell users about.

The measurements, unless otherwise stated, are in millimeters.

## DESCRIPTION

Motor powered bidirectional turnstile made of AISI 304 satin finished stainless steel complete with control board, LED directional arrows, fall-away arm and automatic resetting system, and anti-trespassing system. The tripod automatically releases during power outages. Arms made of AISI 304 steel.

The motor-powered turnstile is selective, in that it allows one person at a time to pass through the chosen direction. Once it receives a command, the tripod turns slightly as an invitation to pass through; as it detects the person's push, it completes the rotation to then reposition itself and wait for a new command. You can choose two other rotating modes: free and locked.

Arm fall-away system: during emergencies or power outages, the horizontal arm drops away to free up the passage.

Anti-trespassing system: trying to force one's way through the turnstile sets off an Encoder-detected buzzer alarm.

Locally programmed and controlled (keypad on the control board) or remotely controlled via CRP.

Alternatively you can program and control the access-point even via readers and corresponding RFID cards.

### Intended use

Used for selecting and authorizing access to zones with high-intensity passages, such as on fair grounds, stadiums, sports centers, parking facilities, shopping malls, metro stations and office buildings.

### Technical data

Model	XVia
Protection rating (IP)	44
Power supply (V - 50/60 Hz)	120/230 AC
Draw when in stand-by (W)	18
Power (W)	180
Maximum number of passage per minute*	30
Apparatus class	I
Weight (Kg)	45
Operating temperature (°C)	-20 ÷ +55

\* Detectable in Free-access mode [Free] (see function F 77) [Controlled] In Controlled mode, access times may vary depending on how quickly access is granted.

### Description of parts

1. Legs
2. Tripode
3. Casing
4. Protective carter
5. Upper cover
6. Cover locks
7. Rotating mechanism
8. Power supply/control unit support
9. Control panel
10. Power switch
11. Power-supply line plug
12. Display unit and LED indicators

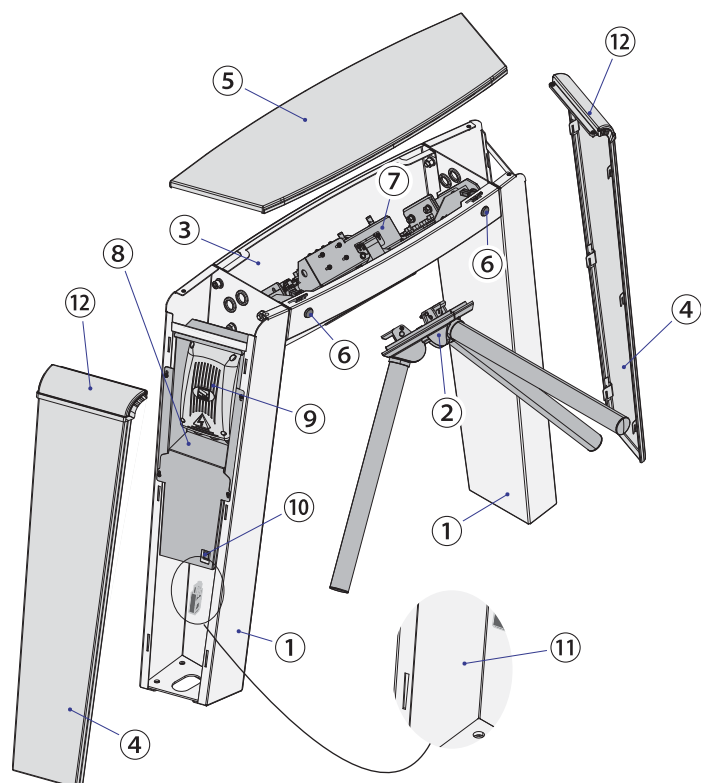

## Dimensions

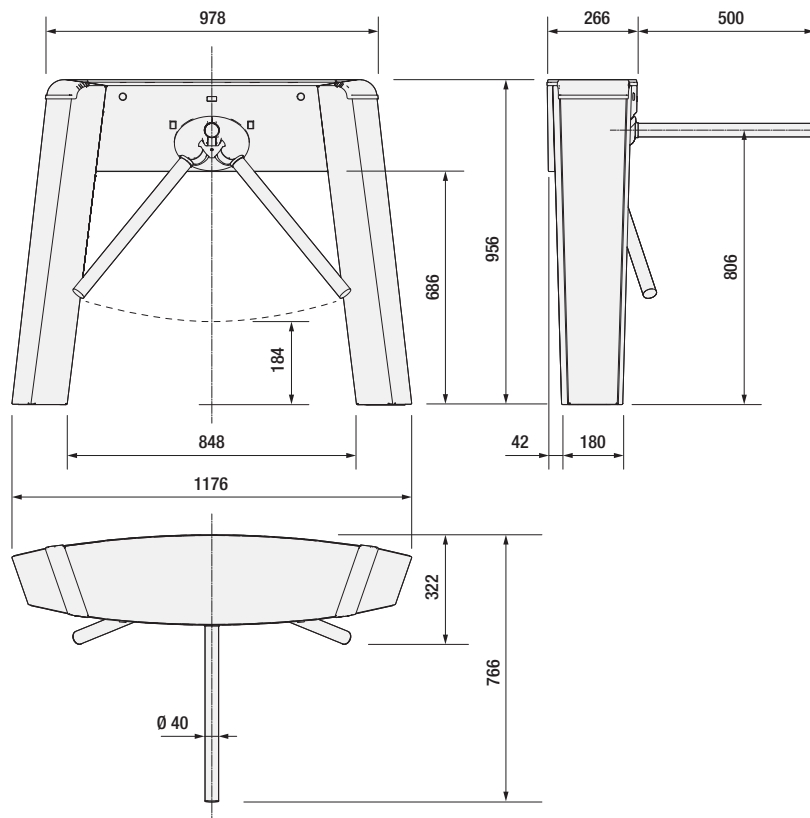

## GENERAL INSTALLATION GUIDELINES

⚠ Only skilled, qualified staff must install this product.

### Preliminary checks

⚠ Before installing the turnstile, you need to:

- if needed, set up corrugated tubing for the electrical cables to pass through;
- set up a dual-pole cut-off switch with minimum contact openings of 3 mm, and section-off the power supply;
- Set up suitable tubes and conduits for the electric cables to pass through, making sure they are protected from any mechanical damage;
- ⚡ Make sure that any connections inside the container (ones that ensure continuity to the protection circuit) are fitted with additional insulation with respect to those of other electrical parts inside.

### Cable type and minimum section

Connection	cable length	
	< 20 m	20 < 30 m
Gearmotor with control board	3G x 1.5 mm <sup>2</sup>	3G x 1.5 mm <sup>2</sup>
Command and control devices	2 x 0.5 mm <sup>2</sup>	2 x 0.5 mm <sup>2</sup>
Safety devices	2 x 0.5 mm <sup>2</sup>	2 x 0.5 mm <sup>2</sup>
24 V accessories	2 x 0.5 mm <sup>2</sup>	2 x 0.5 mm <sup>2</sup>

📖 When operating at 230 V and outdoors, use H05RN-F-type cables that are 60245 IEC 57 (IEC) compliant; whereas indoors, use H05VV-F-type cables that are 60227 IEC 53 (IEC) compliant. For power supplies up to 48 V, you can use FROR 20-22 II-type cables that comply with EN 50267-2-1 (CEI).

To connect to the CRP, use UTP CAT5-type cables up to 1,000 m in length.

📖 If cable lengths differ from those specified in the table, establish the cable sections depending on the actual power draw of the connected devices and according to the provisions of regulation CEI EN 60204-1.

📖 For multiple, sequential loads along the same line, the dimensions on the table need to be recalculated according to the actual power draw and distances. For connecting products that are not contemplated in this manual, see the literature accompanying said products

## Tools and materials

Make sure you have all the tools and materials you will need for installing in total safety and in compliance with applicable regulations. The figure shows some of the equipment installers will need.

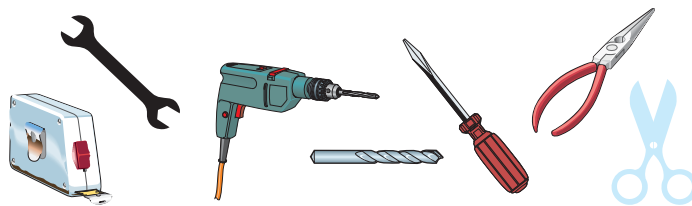

## INSTALLATION

The following illustrations are mere examples. The space for fastening the turnstile and accessories varies depending on the overall dimensions. It is up to the installer to find the most suitable solution.

△ Two people must assemble and fit the turnstile. To transport it and lift it, use proper hoisting equipment.

△ Risk of tipping over! Do not lean onto the turnstile until it is completely set.

### Tracing for fitting the turnstile

The floor onto which the turnstile will be installed must be perfectly level.

If the turnstile is fitted up against a wall, leave at least 5 cm on the side opposite the tripod.

Once you have established the position, trace the axes as shown and mark them using a pencil.

Drill the marked holes and fit the anchors.

 We suggest you use AISI 304 stainless steel nuts and bolts and in any case ones suitable to the type of floor you have; the holes on the structure have a  $\varnothing$  11.

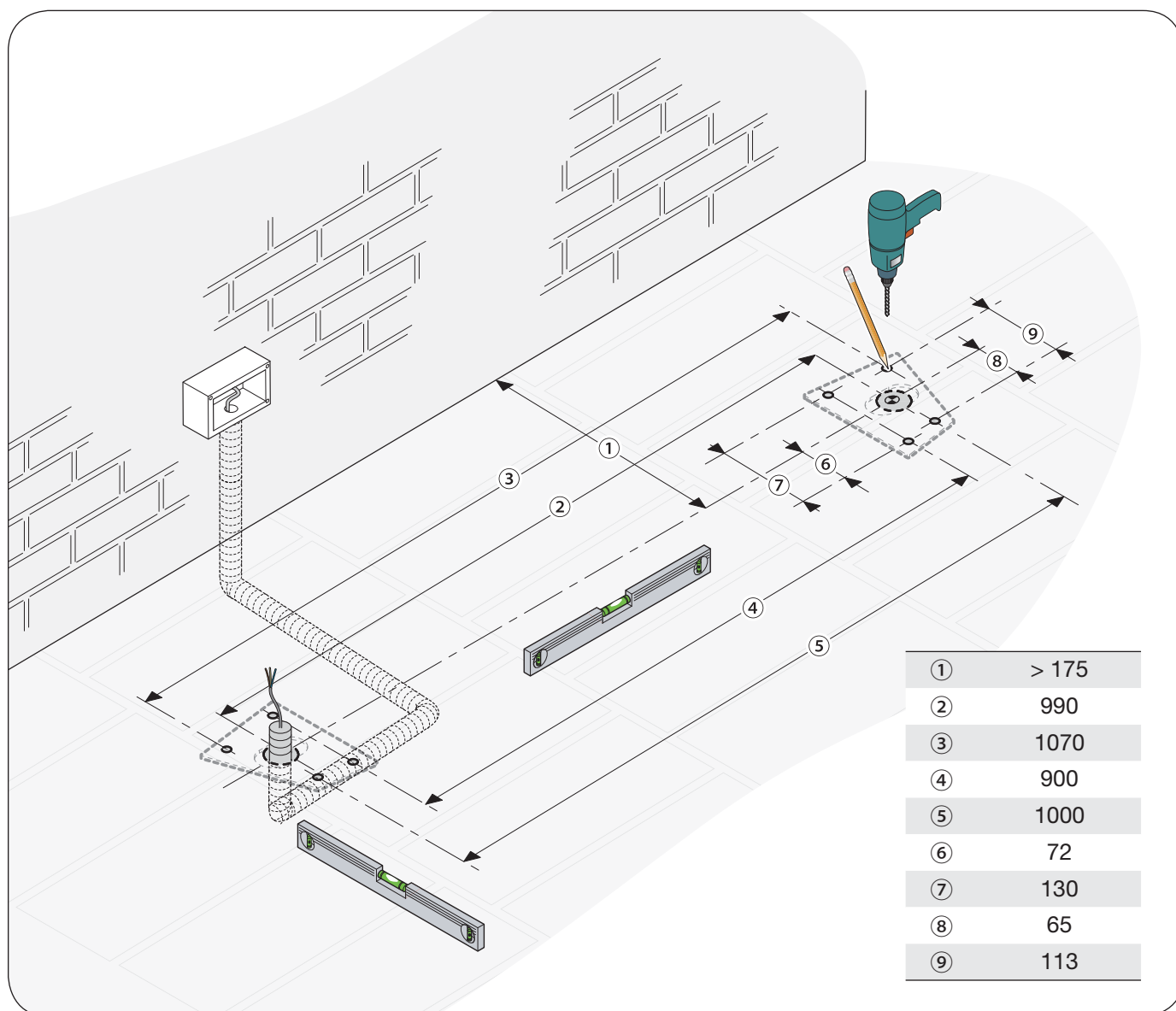

## Preparing the turnstile

Open the locks and remove the top cover, lifting it from the front and pushing it back. **1 2**

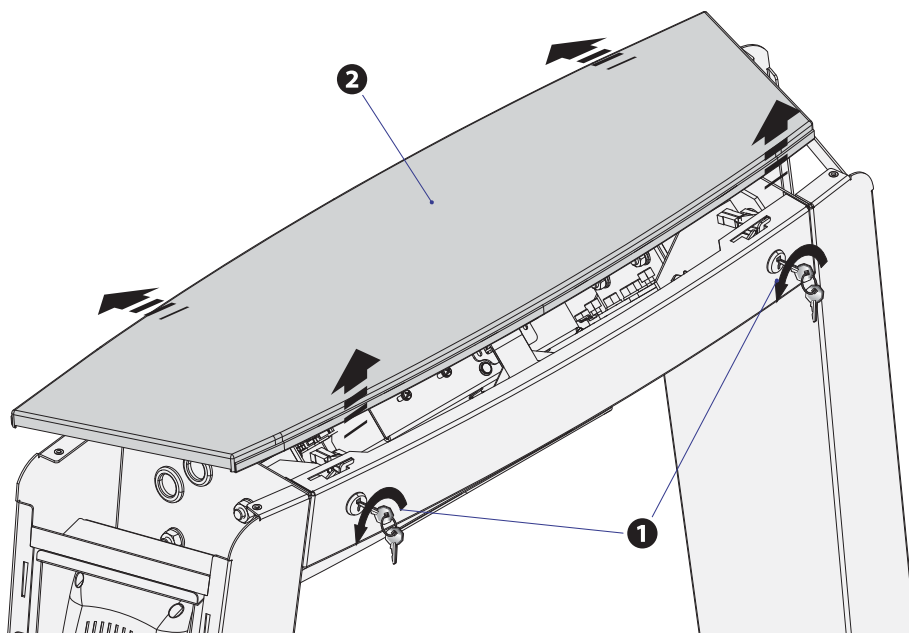

The power-supply and control unit is inside the left leg **3**; you can move it to the right leg, after disconnecting it from the devices. Be careful about the cable lengths, when reconnecting the devices.

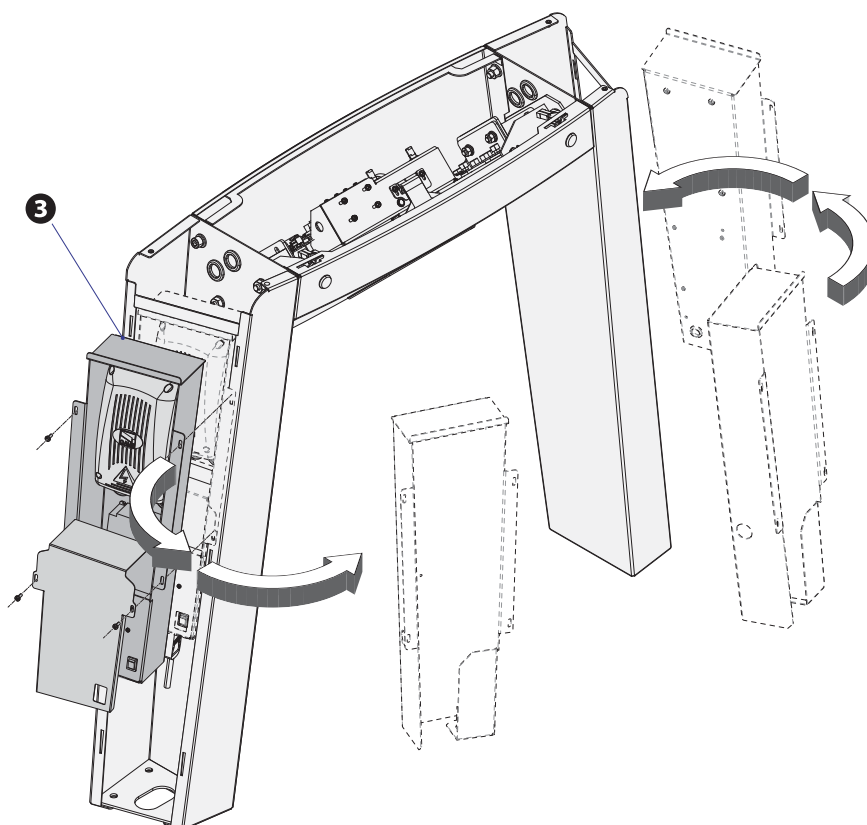

## Preparing the (PSXV03) fixed-arm turnstile

Remove the three ABS covers. **1**

Open the arms to hook up the fastening brace, by turning the latter. **2 3**

Fasten the braces using the supplied M4x8 bolts. **4**

Tighten all nuts and bolts. **5 6**

Refit the ABS covers and fasten them using the 3.9x16 screws. **7**

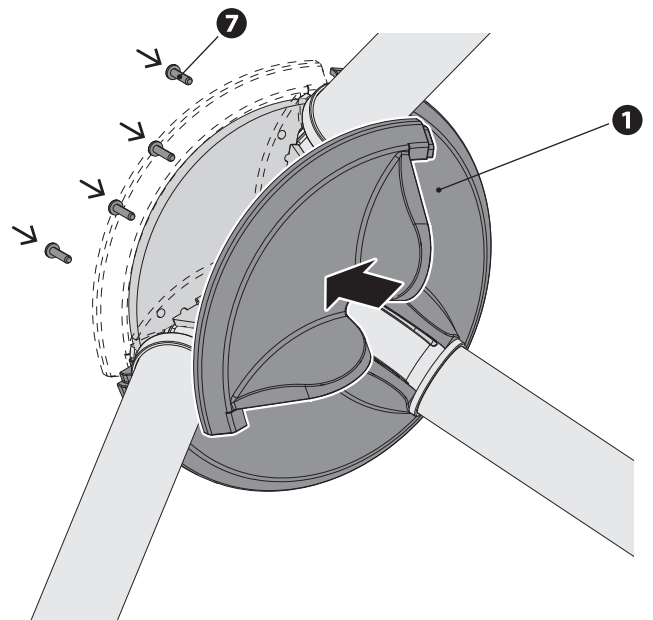
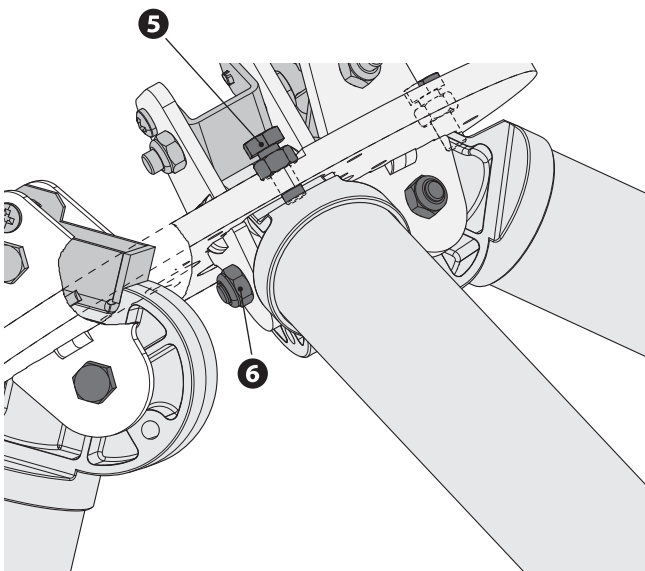
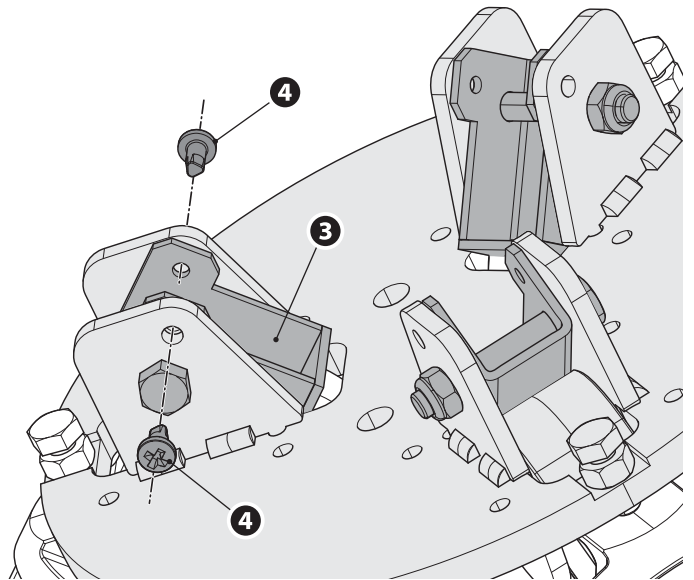
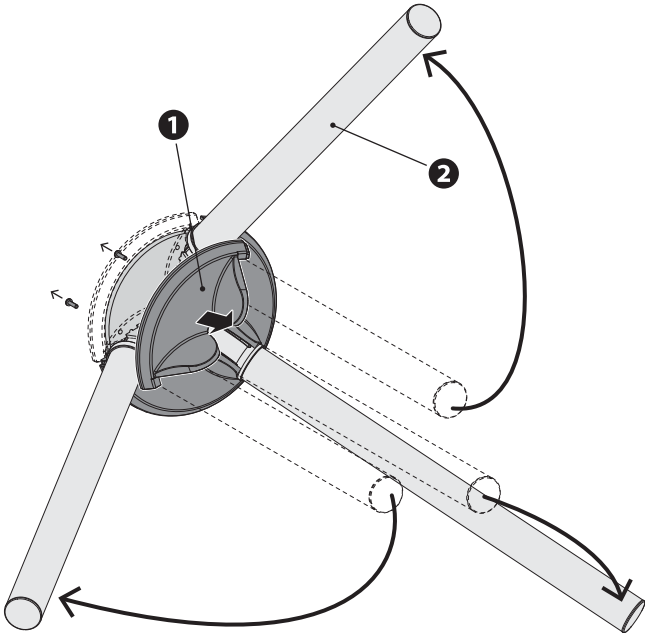



## Fastening the turnstile

Position the turnstile and fasten it soundly.

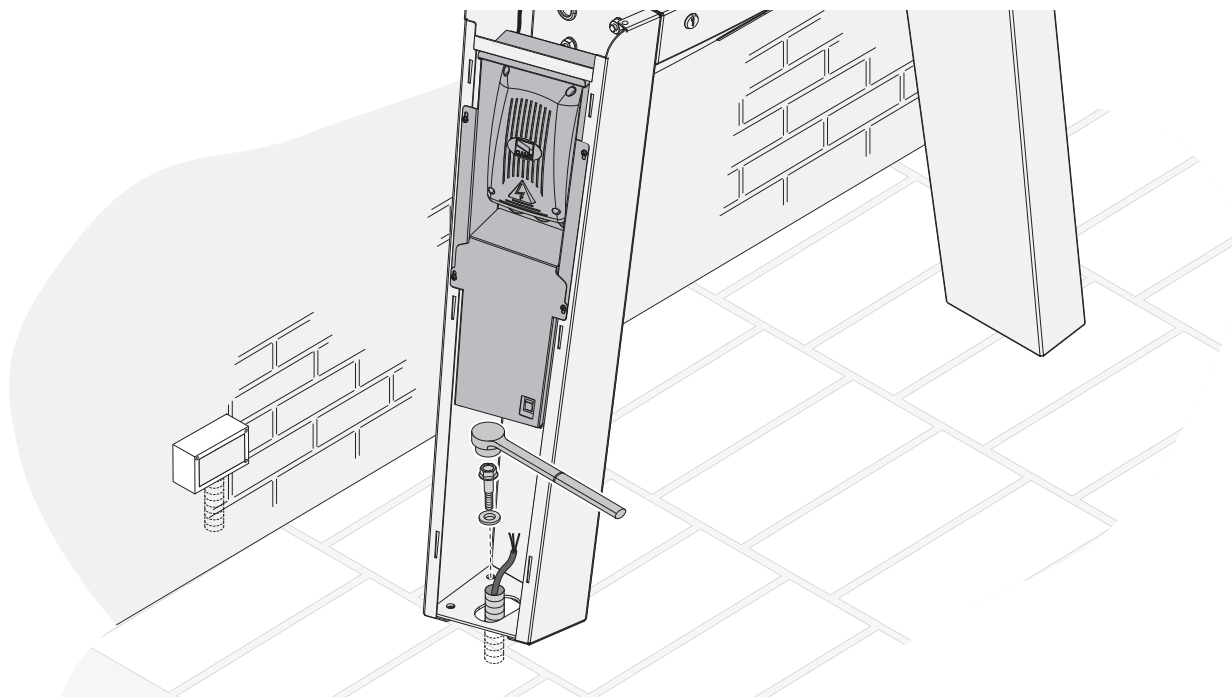

## Fastening the tripod

Open the arms until they mechanically latch. **1**

Fasten the tripod to the rotating mechanism by using the supplied M8x20 nuts and bolts. **2**

Fasten the small cover using the supplied M4x25 bolt **3**

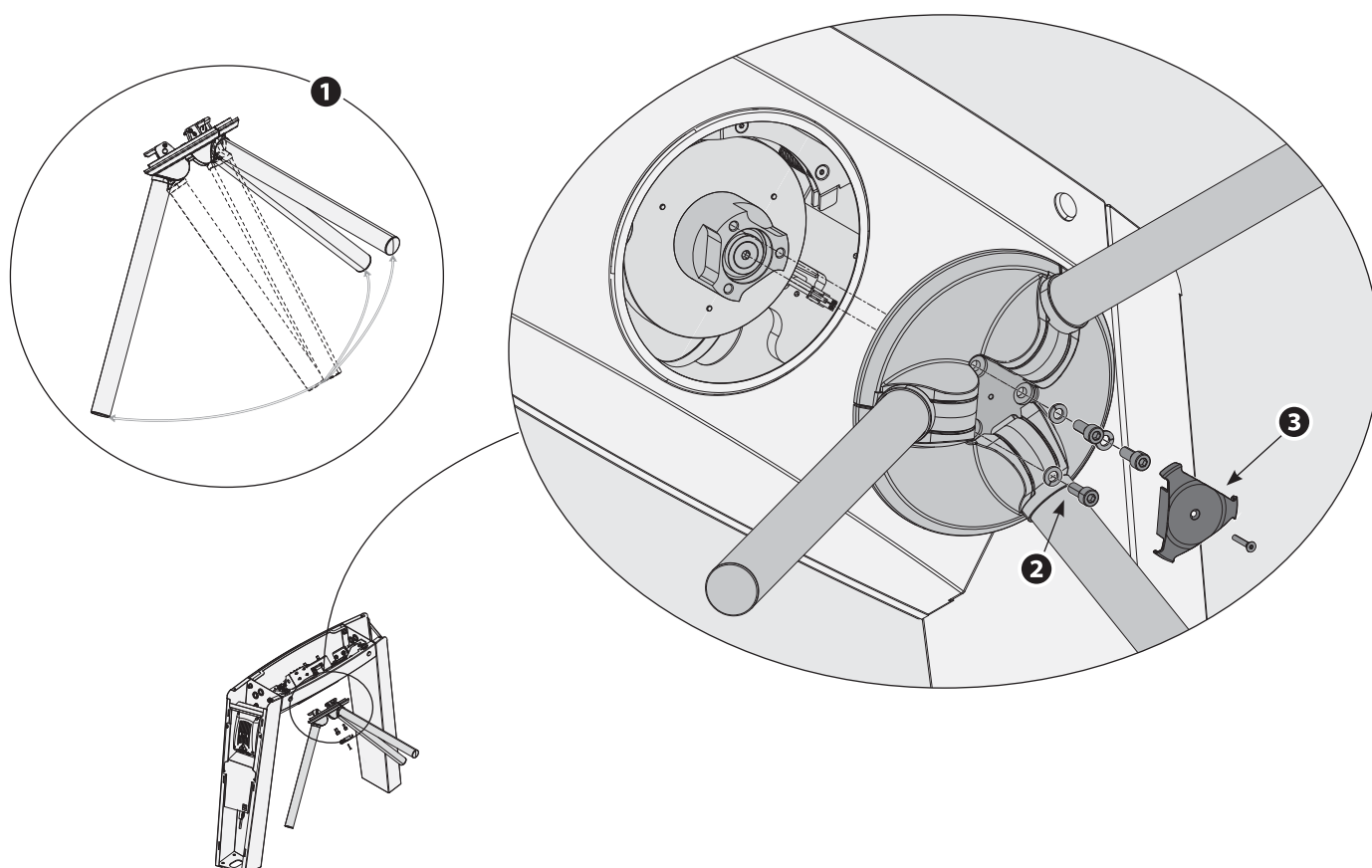



⚠ Before acting on the control board, cut off the main power supply.

📖 The 24 V DC output power is of the SELV type.

All connections are quick-fuse protected.

FUSE TABLE	TOR500
MOTOR -> Motor (A)	3 - F
E.BLOCK -> Electro-lock (A)	2 - F
ACCESSORIES -> Accessories (A)	1 - F

## Description of parts

1. Function programming keys
2. DIP-switch for RS485 terminator
3. CRP connection terminals
4. LED indicator connection terminals
5. Rotation successful relay-output
6. Buzzer terminals
7. Arms rotation sensor terminals
8. Cover micro-switch connection terminals
9. Accessory connection terminal board
10. Encoder terminals
11. Motor terminals
12. Arm fall-away electro-lock terminals
13. Power supply to accessories terminal
14. Control board terminals
15. Accessories fuse
16. Electro-lock fuse
17. Motor fuse
18. Power on LED
19. Restart key

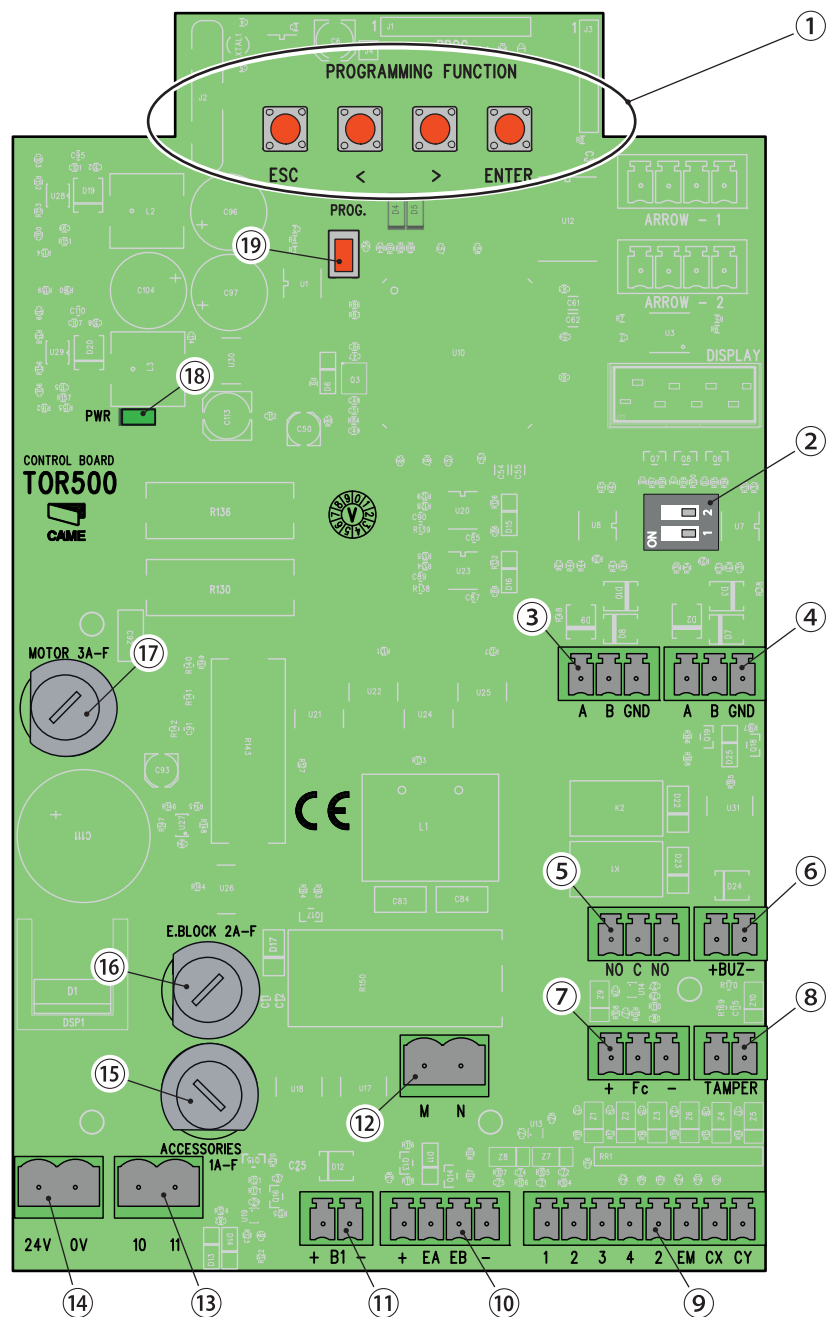

DIP1: set to ON if the cable connecting to the remote control device is longer than 30 m.  
 DIP2: leave on OFF.

## Power supply

Hardwire the plug to the power-supply cable. ❶

Default power supply: 230 V AC

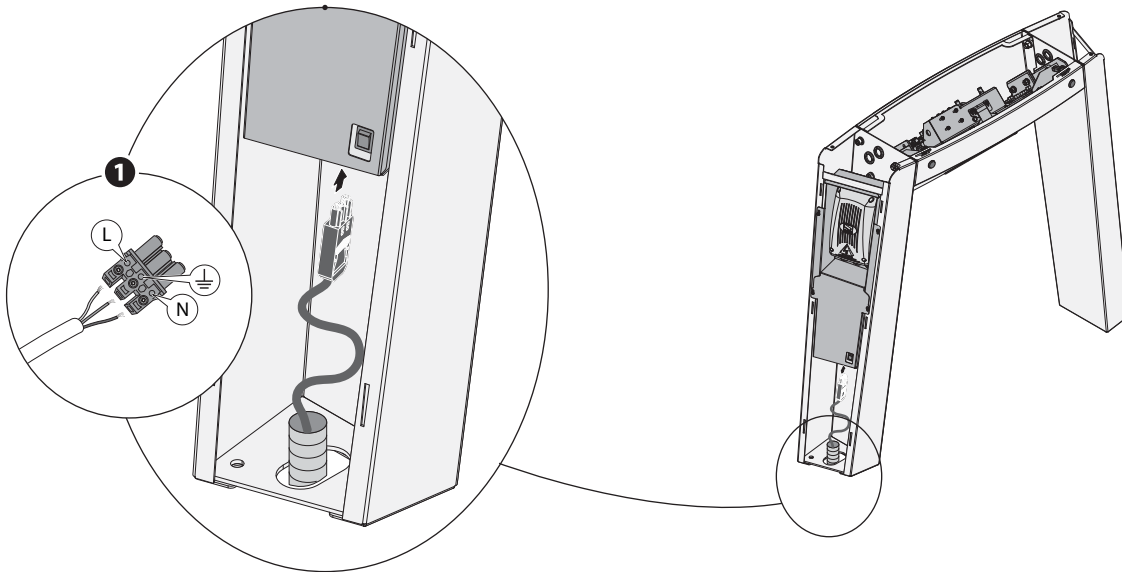

To switch to 120 V current, unplug the power supply and control unit to access, via the lateral hole, the selection lever, and flick it upwards. ❷❸

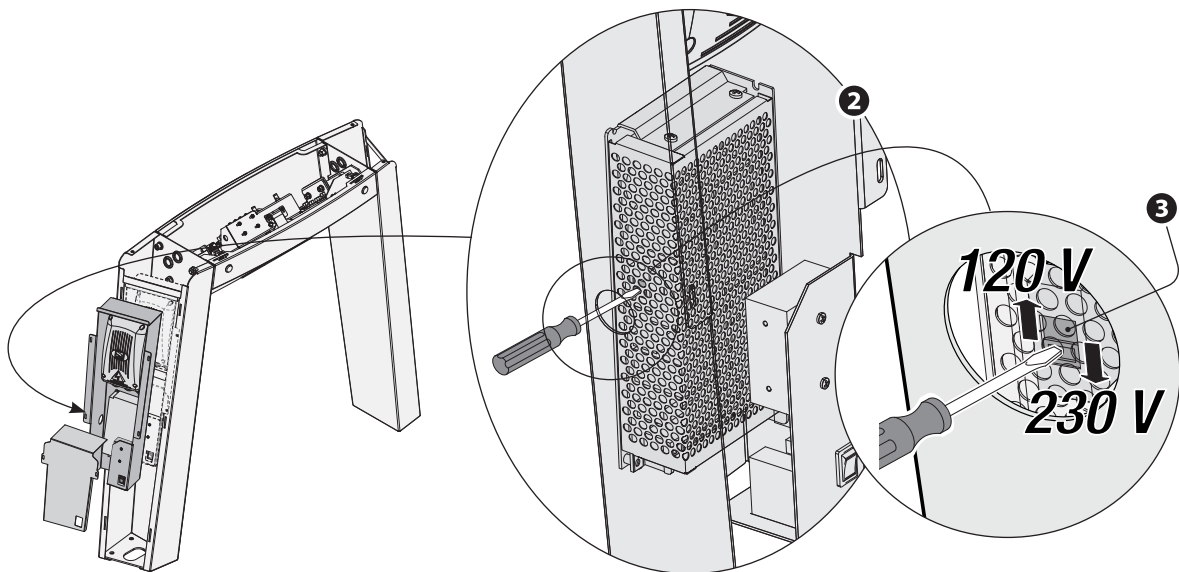

⚠ After connecting the turnstile to the power mains, wait 10 seconds before commanding any maneuver.

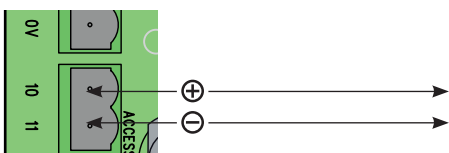

Connections for 24 V DC - max 20W accessories.

## Command and control devices

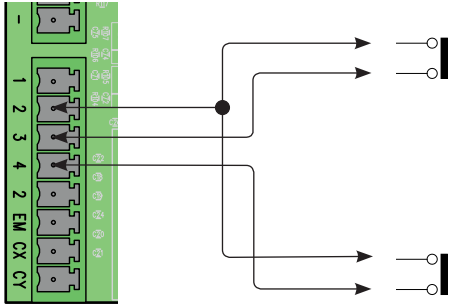

**Command for counter-clockwise operation (NO), with local and remote device.**  
For counter-clockwise release of the turnstile

**Command for clockwise operation (NO), with local and remote device.**  
For clockwise release of the tripod.

## Emergency devices

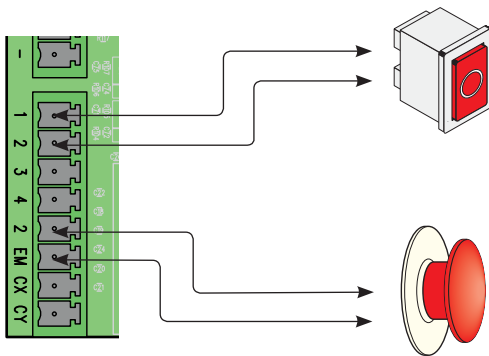

**STOP button (NC).**  
It allows the turnstile to be locked and then repositioned.

**Self-locking release button (NC).**  
It allows the passage to be freed:  
with PSXV02, the horizontal arm drops automatically;  
with PSXV03, the tripod turns freely.

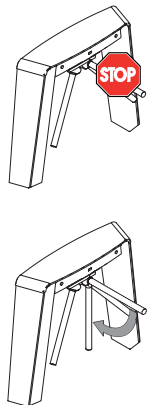

## Remote control device

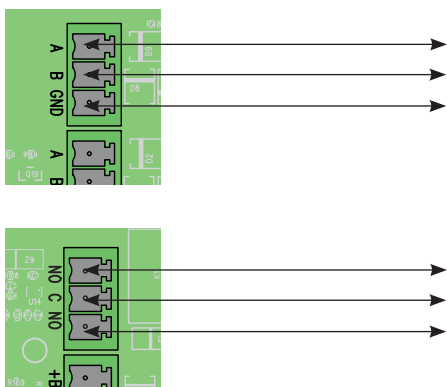

**Remotely controlled CRP connection.**

**Relay output (NO) to signal either clockwise or counter-clockwise rotation.**  
Rated for 24 V DC 500 mA.

You can program directly on the control panel, by opening the turnstile body, or, by installing the PSXVA5/6 kit, with the RFID Master card.

**Menu map**

 Start programming by first performing function A 3 [Calibrate rotation].

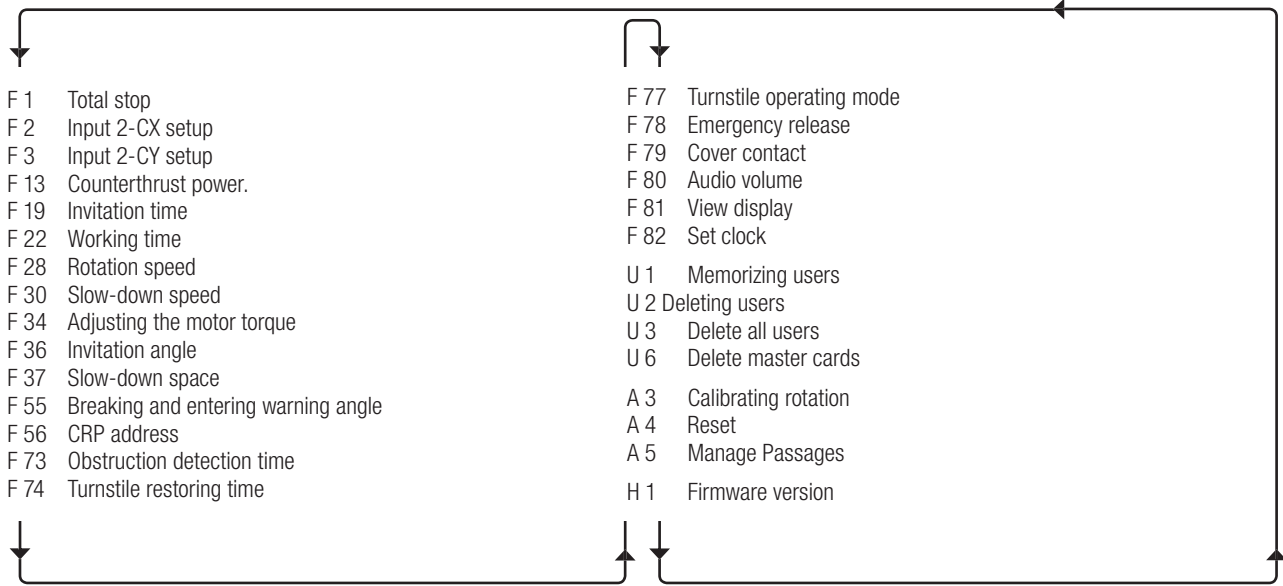

Function	Description (the default values appear with a black backdrop)
F 1	<b>Total Stop.</b> With button connected to terminals 1-2. [ 0 ] Deactivated (obligatory if there is no button); [ 7 ] activated.
F 2	<b>Input 2-CX setup.</b> Only for the anti-trespassing version. [ 0 ] Deactivated; [ 7 ] activated.
F 3	<b>Input 2-CY setup.</b> Only for the anti-trespassing version. [ 0 ] Deactivated; [ 7 ] activated.
F 13	<b>Counter-thrust force.</b> Setting the force that the turnstile counters when forced. [ 20].....[ 30].....[ 50] ] Adjusting to between 20% and 50% of the motor's power.
F 19	<b>Invitation time.</b> Waiting time after pre-rotating (F 36), after which the turnstile returns to its original position and a new command is given. [ 0].....[ 5].....[ 30] ] Adjustable between 1 and 30 seconds. [ 0 ] = deactivated).
F 22	<b>Working Time.</b> Maximum rotation time, after which the turnstile turns freely. [ 5].....[ 30] ] Adjustable between 5 and 30 seconds.
F 28	<b>Rotation speed.</b> Set as a percentage. [ 50].....[ 80].....[ 100] ] Adjustable between 50% and 100% of the motor's speed.
F 30	<b>Slow-down speed.</b> Set as a percentage. [ 15].....[ 20].....[ 40] ] Adjustable between 15% and 40% of the motor's speed.
F 34	<b>Adjusting the motor torque.</b> The turnstile's countering-force during normal accesses. [ 0].....[ 5].....[ 10] ] from minimum to maximum.
F 36	<b>Invitation angle.</b> Turnstile's pre-rotation following an opening command. [ 0].....[ 5].....[ 75] ] Setting the angle between 1 and 30 degrees.
F 37	<b>Slow-down space.</b> Set the slow-down starting angle during the repositioning phase. [ 0].....[ 2].....[ 5] ] setting the angle between 0 and 5 degrees.
F 55	<b>Breaking and entering warning angle.</b> Forced rotation angle, beyond which the turnstile signals a breaking and entering attempt. [ 0 ] Deactivated; [ 0].....[ 10].....[ 30] ] Setting the angle between 1 and 30 degrees.
F 56	<b>CRP address.</b> Univocal logic address for managing the turnstile via CRP. [ 0].....[ 255] ]
F 73	<b>Obstruction detection time.</b> Thrust time after which an obstruction is presumed to be present. [ 0].....[ 5].....[ 10] ] Settable between 1 and 10 seconds.
F 74	<b>Turnstile restoring time.</b> To restore the turnstile's normal functioning after detecting an obstruction. [ 0].....[ 2].....[ 15] ] Adjustable between 1 and 15 seconds.

Function	Description (the default values appear with a black backdrop)																														
F 77	<p><b>Turnstile operating mode.</b> Setting the activity status for each transit direction.</p> <table border="1"> <thead> <tr> <th>Selection</th> <th>IN (entry)</th> <th>OUT (exit)</th> </tr> </thead> <tbody> <tr> <td>[ 0 ]</td> <td>Locked</td> <td>Locked</td> </tr> <tr> <td>[ 1 ]</td> <td>Locked</td> <td>Controlled</td> </tr> <tr> <td>[ 2 ]</td> <td>Controlled</td> <td>Locked</td> </tr> <tr> <td>[ 3 ]</td> <td>Controlled</td> <td>Controlled</td> </tr> <tr> <td>[ 4 ]</td> <td>Locked</td> <td>Free</td> </tr> <tr> <td>[ 5 ]</td> <td>Free</td> <td>Locked</td> </tr> <tr> <td>[ 6 ]</td> <td>Free</td> <td>Controlled</td> </tr> <tr> <td>[ 7 ]</td> <td>Controlled</td> <td>Free</td> </tr> <tr> <td>[ 8 ]</td> <td>Free</td> <td>Free</td> </tr> </tbody> </table> <p><b>LEGEND:</b></p> <ul style="list-style-type: none"> <li>• <b>Controlled</b> = passage allowed only for authorized users (<b>green arrow lit up</b>);</li> <li>• <b>Free</b> = free passage for all (<b>flashing green arrow</b>);</li> <li>• <b>Locked</b> = passage locked for all (<b>red arrow lit up</b>).</li> </ul>	Selection	IN (entry)	OUT (exit)	[ 0 ]	Locked	Locked	[ 1 ]	Locked	Controlled	[ 2 ]	Controlled	Locked	[ 3 ]	Controlled	Controlled	[ 4 ]	Locked	Free	[ 5 ]	Free	Locked	[ 6 ]	Free	Controlled	[ 7 ]	Controlled	Free	[ 8 ]	Free	Free
Selection	IN (entry)	OUT (exit)																													
[ 0 ]	Locked	Locked																													
[ 1 ]	Locked	Controlled																													
[ 2 ]	Controlled	Locked																													
[ 3 ]	Controlled	Controlled																													
[ 4 ]	Locked	Free																													
[ 5 ]	Free	Locked																													
[ 6 ]	Free	Controlled																													
[ 7 ]	Controlled	Free																													
[ 8 ]	Free	Free																													
F 78	<b>Emergency release.</b> With the button connected to 2-EM. [ 0 ] Deactivated; [ 7 ] activated.																														
F 79	<b>Cover contact.</b> Inhibits any movement when the cover is off. [ 0 ] Deactivated; [ 7 ] activated.																														
F 80	<b>Audio volume.</b> Adjust the buzzer volume. [ 0 ] Disabled; [ 7].....[ 5].....[ 70 ] for adjusting the volume.																														
F 81	<b>Display viewing.</b> Choosing which datum to view on the display. [ 0 ] Disabled; [ 7 ] for viewing passages; [ 2 ] for viewing theclock.																														
F 82	<b>Set the clock.</b> See detail in corresponding chapter.																														
U 1	<b>Memorize users.</b> See detail in corresponding chapter.																														
U 2	<b>Delete users.</b> See detail in corresponding chapter.																														
U 3	<b>Delete all users.</b> See detail in corresponding chapter.																														
U 6	<b>Delete Master Cards.</b> See details in corresponding chapter.																														
A 1	<b>Type of FW installed.</b> Read only. [ 7 ] FW for Stand Alone XVIA; [ 2 ] FW for Expo XVIA .																														
A 3	<b>Calibrate rotation.</b> Adjusting the rotation. [ 7 ] For calibrating.																														
A 4	<b>Reset.</b> To restore all default parameters. [ 7 ] For resetting.																														
A 5	<b>Managing passages.</b> It zeros out the partial count of passages or displays the total passages (not subject to zeroing out or resetting). [ 0 ] To exit; [ 7 ] for zeroing out the partial count; [ 2 ] for viewing the total count.																														
H 1	<b>Firmware version.</b>																														

## Description of the control panel's programming commands

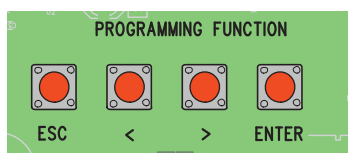

The key is **ENTER** for

- entering the programming mode (keep it pressed for about 2 seconds.)
- entering single menus
- confirming/memorizing the values you set

The keys < > are for

- moving from one item to another
- increasing or decreasing values

The key is **ESC** for exiting the menus without saving any changes

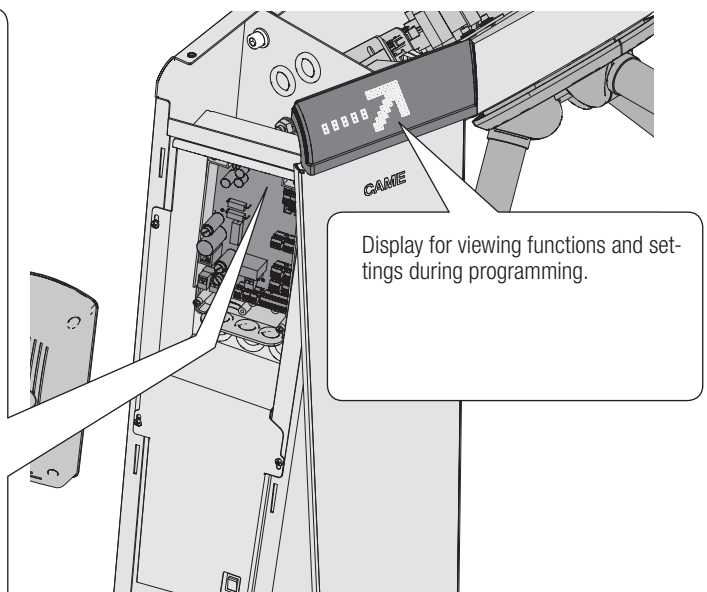

## Description of programming commands with RFID cards

The PSXVA5/6 kit is for programming even with an RFID Master card.

\* The first [U0001] and the second [U0002] cards both become master cards and can be memorized only from the control panel (see Memorize Users function).

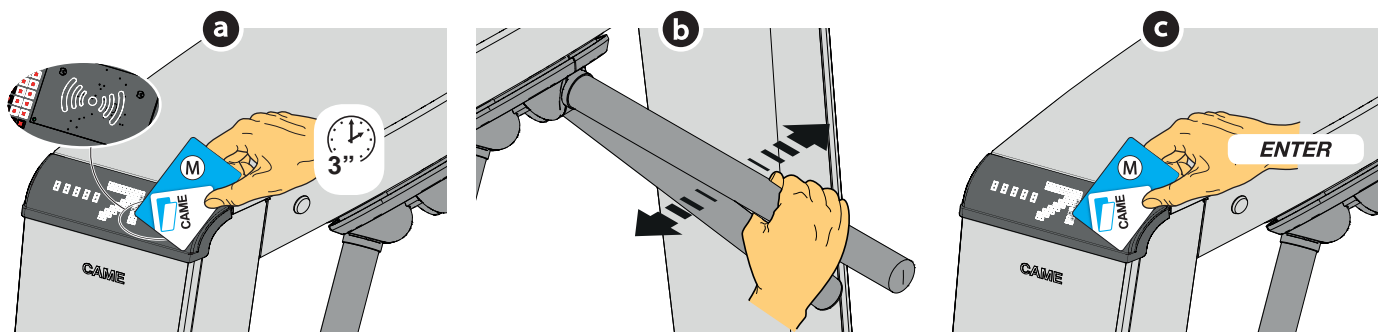

**a** Press the master card against the sensor for longer than three seconds to access the programming mode.

either a cursor line appears `F 1` or the digits' status changes on the display (they switch from flashing to fixed).

**b** Push the arm either clockwise or counter-clockwise to browse the menu or edit values in your settings.

**c** Swipe the master card past the sensor to confirm, or to exit the menu.

To exit the menus without saving your changes, wait 20 seconds (this corresponds to the control panel's ESC function).

### U 1 - Memorize User (250 max.)

- Enter the programming mode, select Memorize user [U1] and then [1].
- The first available position for memorizing will appear. The available positions are the flashing ones. When you have reached the maximum number of users, the wording [FULL] will appear
- Swipe the cards, you wish to memorize, past the sensor: after the last card passes by the display will stay lit for a few seconds to confirm that memorization was successful.

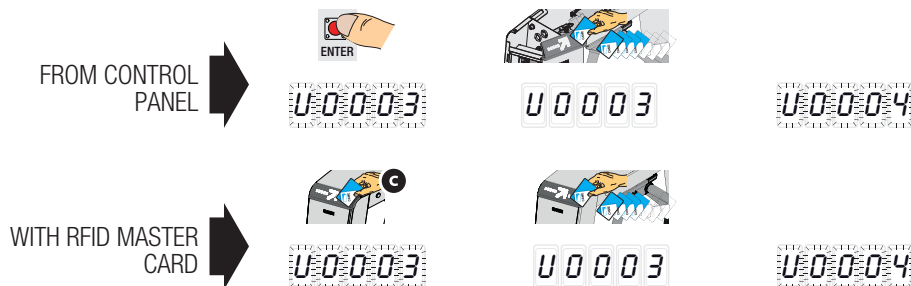

### U 2 - Delete users

- Enter the programming mode and select [U2] Delete users and then [1];
- the first position, taken by a memorized user, will flash;
- If [----] appears it means there are no memorized users.
- find the user or swipe the card you wish to delete past the sensor;
- press the [ENTER] key or swipe the master card past the sensor to confirm the deletion; the viewer returns to the first user;

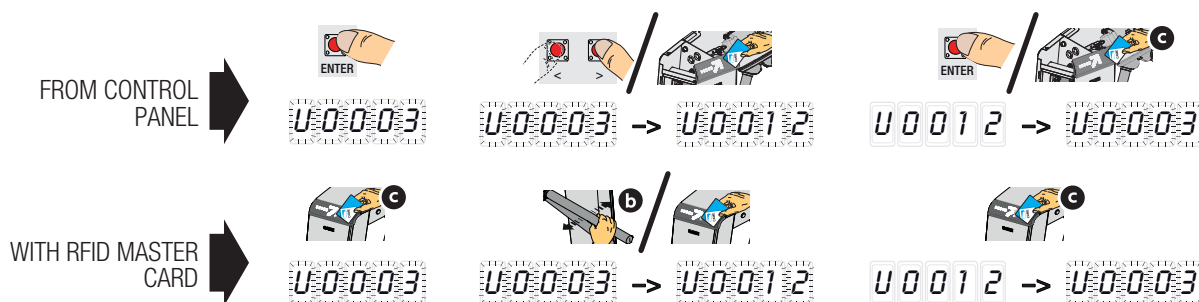

### U 3 - Delete all users

- Enter the programming mode and select Delete all users [U3] and then [1];
- once you activate the function, the flashing wording [CLrA] will appear;
- press the [ENTER] key or swipe the master card past the sensor to confirm deletion; the wording [CLr] will appear on the display to confirm al users have been deleted (excluding master cards);
- Exit the programming mode.

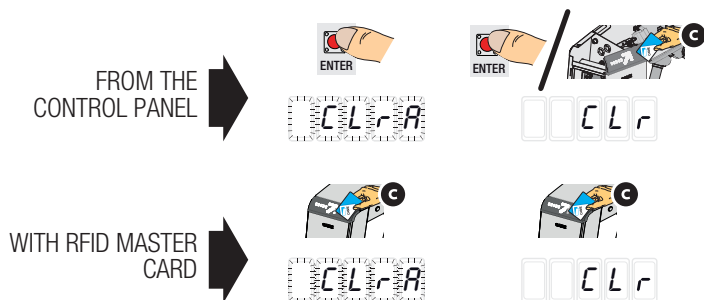

### U 6 - Delete master cards

- Enter the programming mode and select Delete master cards [U6] and then [1];
- once you activate the function, the flashing wording [CL--] will appear;
- press the [ENTER] key to delete both master cards, or swipe master card 1 to delete master card 2, and vice versa: the [CL1]/[CL2] wording will be displayed to confirm deletion of both the master cards;
- Exit the procedure.

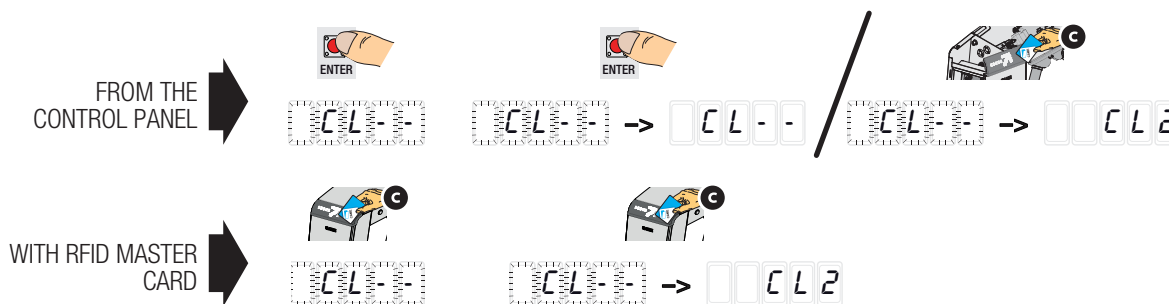

### F 82 - Set the clock

- Enter the programming mode and select Set the clock [F82];
- once the function is activated, the following will appear in sequence:
  - ⌘ 1 0 0 by year, ⌘ 2 1 2 by month, ⌘ 3 3 1 by month,
  - ⌘ 4 2 3 by hour, ⌘ 5 5 9 by minutes, ⌘ 6 5 9 by seconds,
  - ⌘ 7 0 0 for editing the time limit:
    - ⌘ 7 0 3 increase to add about 10 seconds per month, at a time (max. 9 = 95s)
    - ⌘ 7 0 - 3 decrease to remove about 10 seconds per month, at a time (max. 9 = 95s)
    - 📖 we suggest checking if the setting is right after at least one month;
  - ⌘ 8 0 0 to activate daylight savings time ([ 0 ] deactivated);
- exit the procedure.

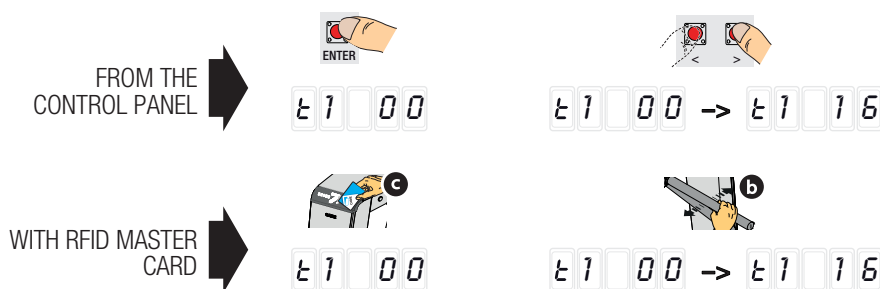



## FINAL OPERATIONS

Once the electrical connections and commissioning are done, fit the lateral carters. **1 2 3**

Connect the LED signal lights by using the corresponding terminals. **4**

Refit the cover and lock the locks. **5 6**

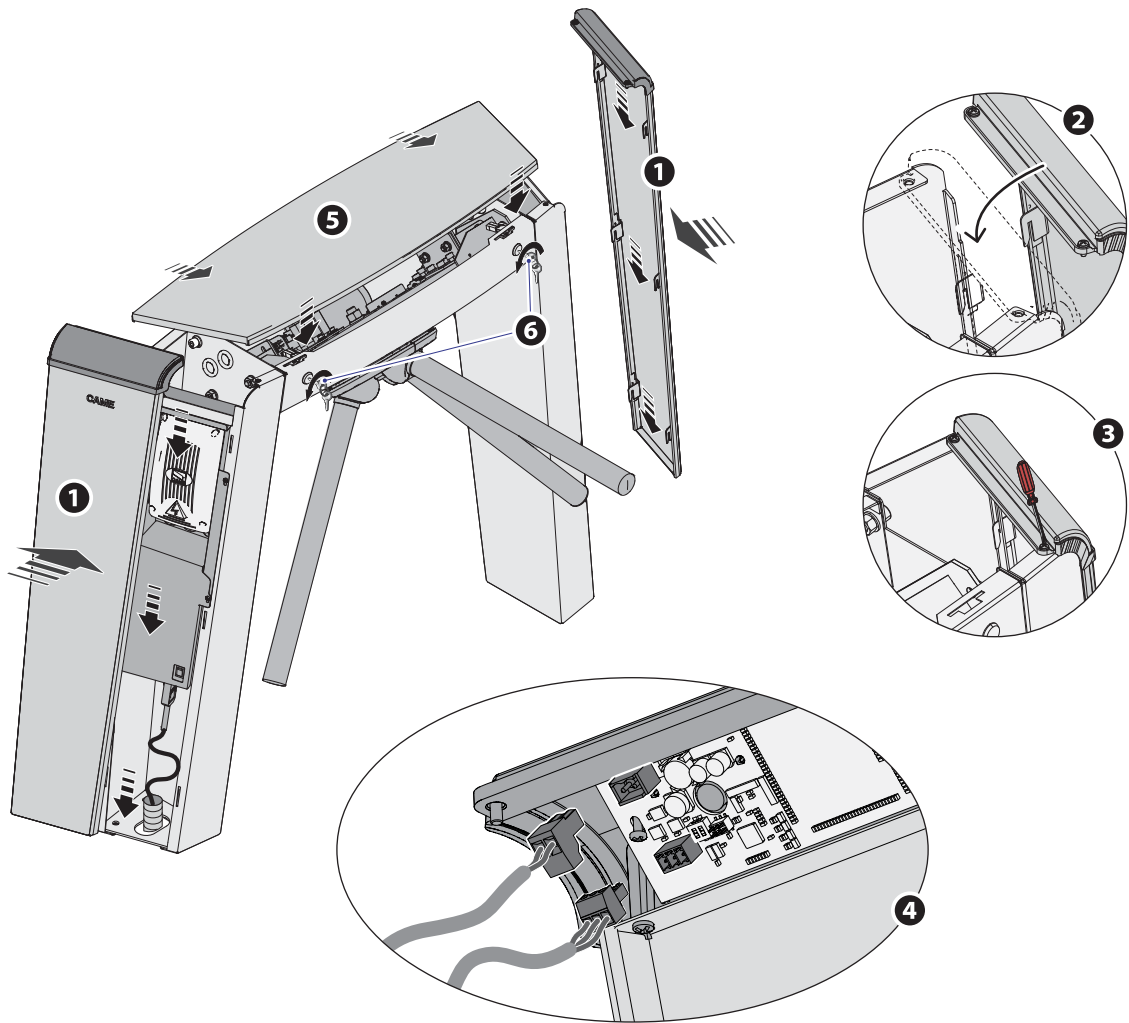

## MAINTENANCE

**⚠** Before doing any maintenance, cut off the power supply, to prevent any hazardous situations caused by accidentally activating the operator.

**📖** To properly maintain the AISI 304 stainless steel, refer to the stainless steel cleaning part of the 119RW48 manual (<https://docs.came.com> and type inox).

Table of the mean cycles between failures (MCBF) of XVIA turnstiles, considering proper installation and maintenance as described in this manual:

Model	Operating limits	MCBF
001PSXV02	Maximum number of daily cycles: continuous service	3,000,000
001PSXV3	Maximum number of cycles per minute: 30 (1 cycle every 2 seconds)	

### Periodic maintenance

- Every 1,000,000 cycles and, anyhow, every six months:
  - With the mains power cut off, check for smooth sliding and gearmotor reversibility;
  - check proper fastening of the nuts;
  - clean the inside of the operator from any dust created during operation;
  - check tightness of bolts on tripod head;
  - check efficiency of the fall-away arm;
  - check that all electrical and wiring connections are sound;
  - wipe clean the LED signal lights using a cloth moistened only with water;
  - check that the tripod's rotation is properly calibrated (you may have to reprogram the corresponding functions)

## Troubleshooting

PROBLEM	POSSIBLE CAUSES	FIXES AND REMEDIES
The turnstile does not execute commands	<ul style="list-style-type: none"><li>• No power supply</li><li>• The STOP button does not work</li></ul>	<ul style="list-style-type: none"><li>• Check power network</li><li>• Check the button's connection and soundness</li></ul>

## Error messages and notices during installation

ERROR	CAUSE	FIXES
E 1 t	<ul style="list-style-type: none"><li>• Calibration interrupted</li></ul>	<ul style="list-style-type: none"><li>• Redo calibration</li></ul>
E 3	<ul style="list-style-type: none"><li>• Encoder broken</li></ul>	<ul style="list-style-type: none"><li>• Replace the encoder</li></ul>
E 7	<ul style="list-style-type: none"><li>• Operating time exceeded</li></ul>	<ul style="list-style-type: none"><li>• Check gearmotor's state of operation</li></ul>
E 8	<ul style="list-style-type: none"><li>• Cover open</li></ul>	<ul style="list-style-type: none"><li>• Close the cover</li></ul>
E 9	<ul style="list-style-type: none"><li>• Tripod manhandled</li></ul>	
E 10	<ul style="list-style-type: none"><li>• Obstruction during rotation</li></ul>	<ul style="list-style-type: none"><li>• Remove obstruction</li></ul>
E 20	<ul style="list-style-type: none"><li>• Fallen arm</li></ul>	<ul style="list-style-type: none"><li>• Check the release button on 2-EM</li></ul>
E 21	<ul style="list-style-type: none"><li>• Tripod trespassed</li></ul>	<ul style="list-style-type: none"><li>• Contact technical assistance</li></ul>

## DISMANTLING AND DISPOSAL

 CAME S.p.A. applies a certified Environmental Management System at its premises, which is compliant with the UNI EN ISO 14001 standard to ensure the environment is safeguarded.

Please continue safeguarding the environment. At CAME we consider it one of the fundamentals of our operating and market strategies. Simply follow these brief disposal guidelines:

### DISPOSING OF THE PACKAGING

The packaging materials (cardboard, plastic, and so on) should be disposed of as solid household waste, and simply separated from other waste for recycling. Always make sure you comply with local laws before dismantling and disposing of the product.

DO NOT DISPOSE OF IN NATURE!

### DISMANTLING AND DISPOSAL

Our products are made of various materials. Most of these (aluminum, plastic, iron, electrical cables) is classified as solid household waste. They can be recycled by separating them before dumping at authorized city plants.

Whereas other components (control boards, batteries, transmitters, and so on) may contain hazardous pollutants. These must therefore be disposed of by authorized, certified professional services.

Before disposing, it is always advisable to check with the specific laws that apply in your area.

DO NOT DISPOSE OF IN NATURE!

## REFERENCE REGULATIONS

The product complies to the reference regulations in effect.

U0001	MASTER 1	U0050	U0099
U0002	MASTER 2	U0051	U0100
U0003		U0052	U0101
U0004		U0053	U0102
U0005		U0054	U0103
U0006		U0055	U0104
U0007		U0056	U0105
U0008		U0057	U0106
U0009		U0058	U0107
U0010		U0059	U0108
U0011		U0060	U0109
U0012		U0061	U0110
U0013		U0062	U0111
U0014		U0063	U0112
U0015		U0064	U0113
U0016		U0065	U0114
U0017		U0066	U0115
U0018		U0067	U0116
U0019		U0068	U0117
U0020		U0069	U0118
U0021		U0070	U0119
U0022		U0071	U0120
U0023		U0072	U0121
U0024		U0073	U0122
U0025		U0074	U0123
U0026		U0075	U0124
U0027		U0076	U0125
U0028		U0077	U0126
U0029		U0078	U0127
U0030		U0079	U0128
U0031		U0080	U0129
U0032		U0081	U0130
U0033		U0082	U0131
U0034		U0083	U0132
U0035		U0084	U0133
U0036		U0085	U0134
U0037		U0086	U0135
U0038		U0087	U0136
U0039		U0088	U0137
U0040		U0089	U0138
U0041		U0090	U0139
U0042		U0091	U0140
U0043		U0092	U0141
U0044		U0093	U0142
U0045		U0094	U0143
U0046		U0095	U0144
U0047		U0096	U0145
U0048		U0097	U0146
U0049		U0098	U0147



*English - Manual: FA00384-EN v. 2 - 08/2016 - © CAME S.p.A.  
The data and information in this manual may be changed at any time and without notice.*

**CAME**  
safety&comfort

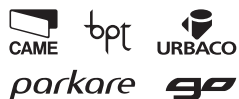

**CAME S.p.A.**

Via Martiri Della Libertà, 15

31030 **Dosson di Casier**  
**Treviso - Italy**

📞 (+39) 0422 4940

📠 (+39) 0422 4941

Via Cornia, 1/b - 1/c

33079 **Sesto al Reghena**  
**Pordenone - Italy**

📞 (+39) 0434 698111

📠 (+39) 0434 698434

**www.came.com**